

SCHEDULE 'A' ZONE MAPS

TOWNSHIP OF PITTSBURGH

ZONING BY-LAW NO. 32-74

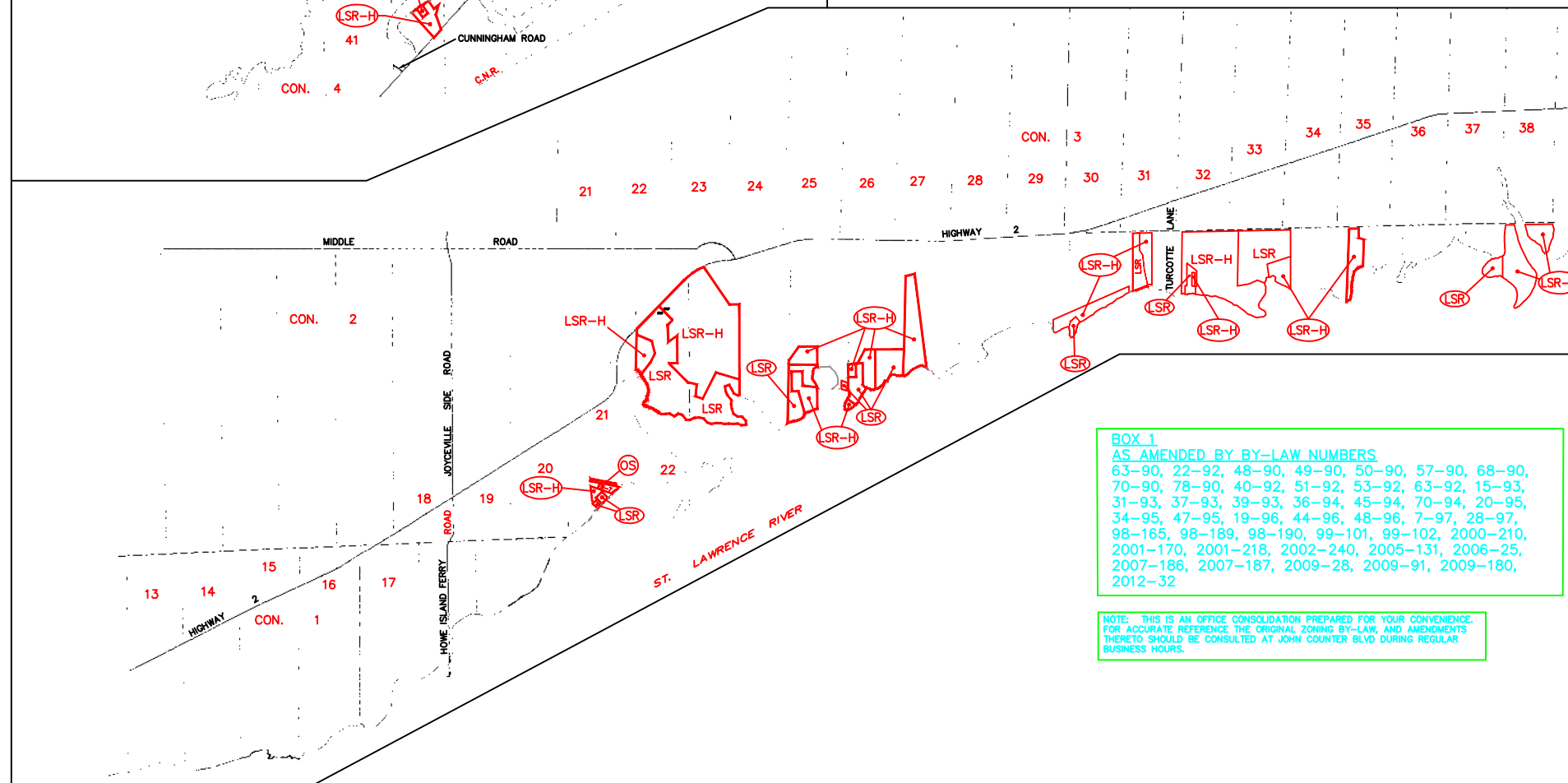
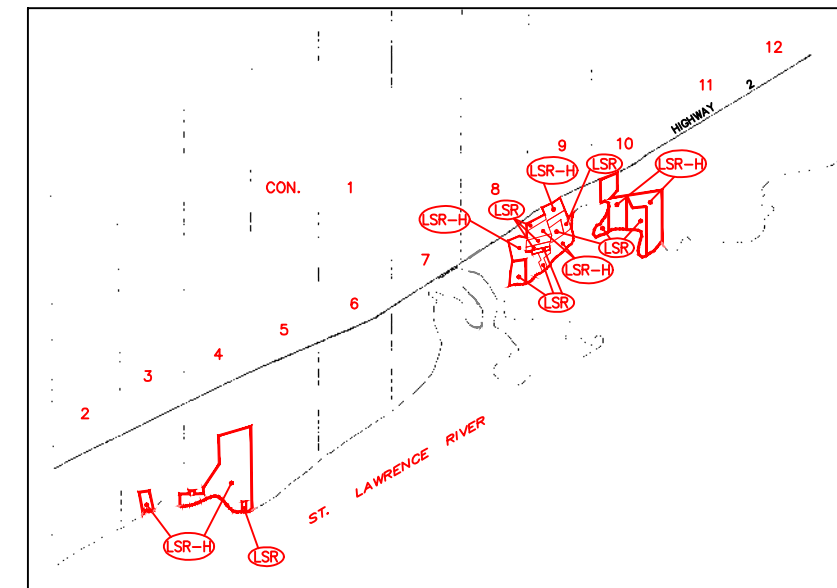
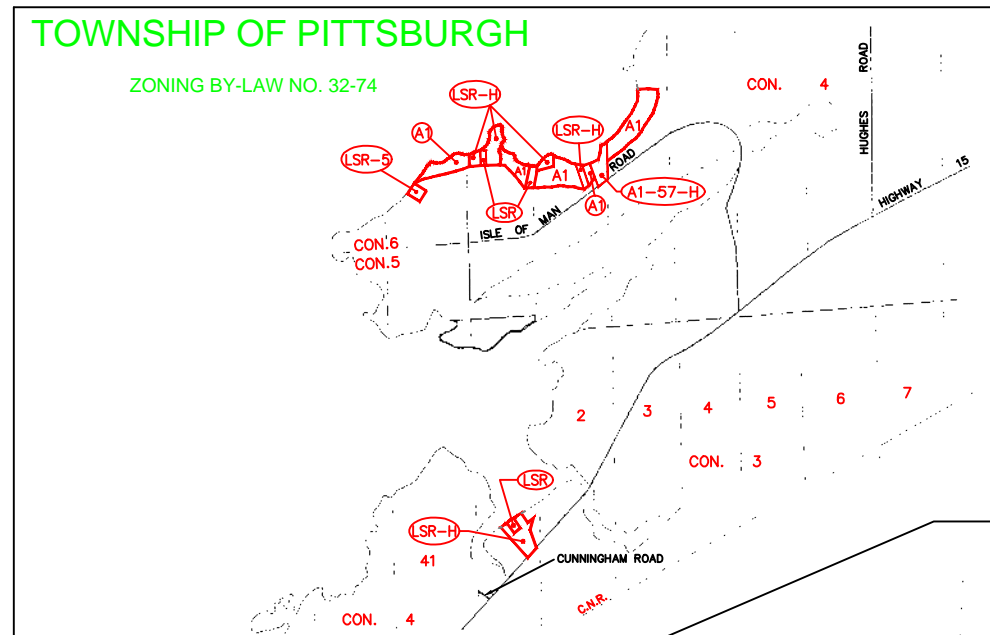

BOX 1
AS AMENDED BY BY-LAW NUMBERS
63-90, 22-92, 48-90, 49-90, 50-90, 57-90, 68-90,
70-90, 78-90, 40-92, 51-92, 53-92, 63-92, 15-93,
31-93, 37-93, 39-93, 36-94, 45-94, 70-94, 20-95,
34-95, 47-95, 19-96, 44-96, 48-96, 7-97, 28-97,
98-165, 98-189, 98-190, 99-101, 99-102, 2000-210,
2001-170, 2001-218, 2002-240, 2005-131, 2006-25,
2007-186, 2007-187, 2009-28, 2009-91, 2009-180,
2012-32

NOTE: THIS IS AN OFFICE CONSOLIDATION PREPARED FOR YOUR CONVENIENCE.
FOR ACCURATE REFERENCE THE ORIGINAL ZONING BY-LAW, AND AMENDMENTS
THERE TO SHOULD BE CONSULTED AT JOHN COUNTER BLVD DURING REGULAR
BUSINESS HOURS.

MAP 5

TOWNSHIP OF PITTSBURGH
SCHEDULE 'A'

LEGEND

— ZONE BOUNDARY
A1 ZONE

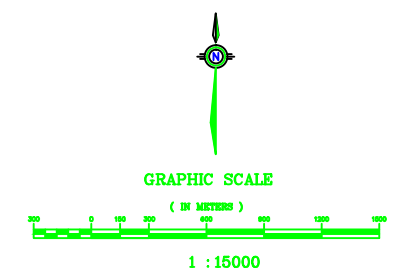

REVISED DECEMBER 2011